

ASSEMBLY INSTRUCTION

418-000001

2/1 Page

Thank you for purchasing this quality product. Be sure to check all packing material carefully for small parts that may have come loose inside the carton during shipment.

PART LIST:



Feet 6 PCS

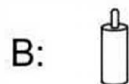

Hidden Feet 8 PCS

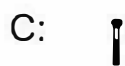

Screw
24*3 cm



Long Connection
Apparatus 3 PCS



Connection Apparatus
6 PCS



Crimping Apparatus
12 PCS

1. PROCEDURE

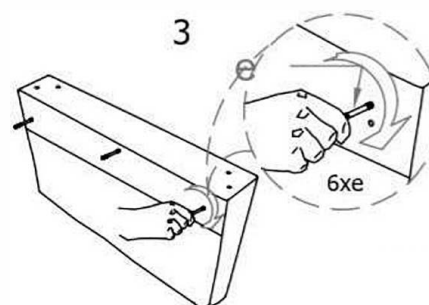
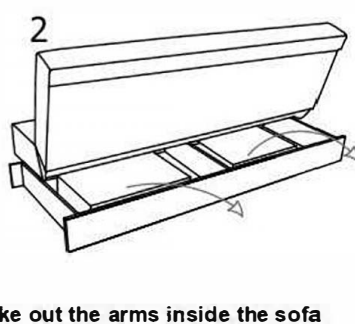
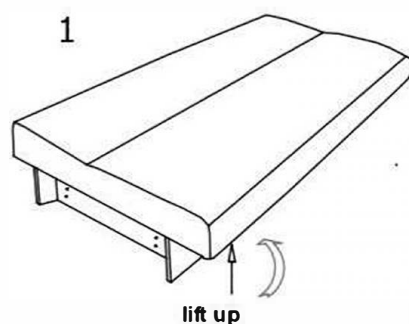

Attach The Apparatus To The Places Shown
Rotate And Squeeze

2. PROCEDURE

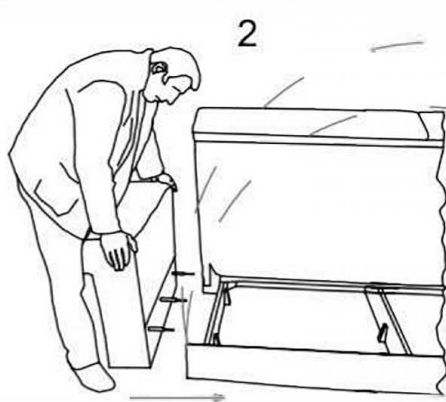

Attach the Arm to the Sofa

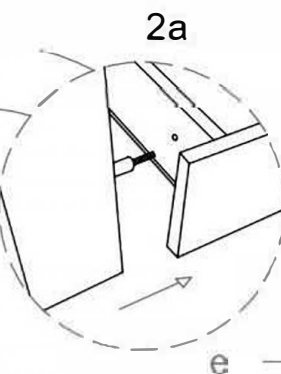

Pass The Apparatus Through The Hole

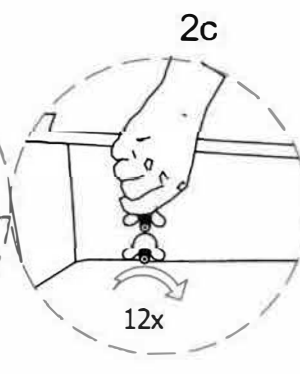
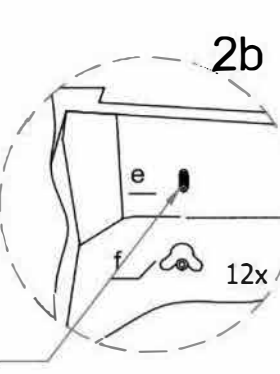

Apparatus clamping

3. PROCEDURE

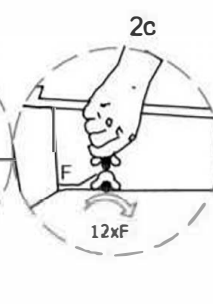
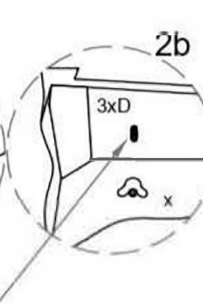
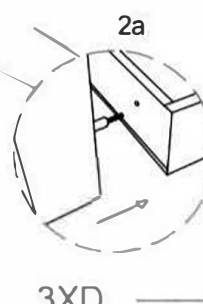
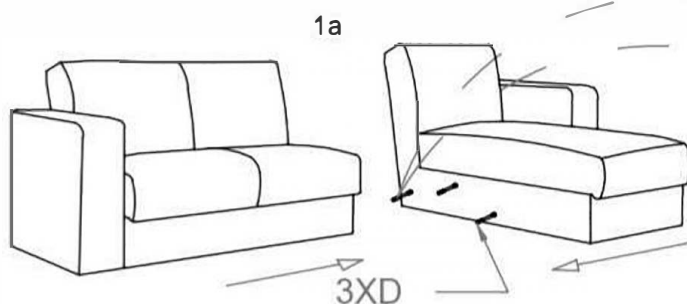

4. PROCEDURE

WARNING

!!!

The leg of the sofa must be attached to the specified place and exactly at the corners

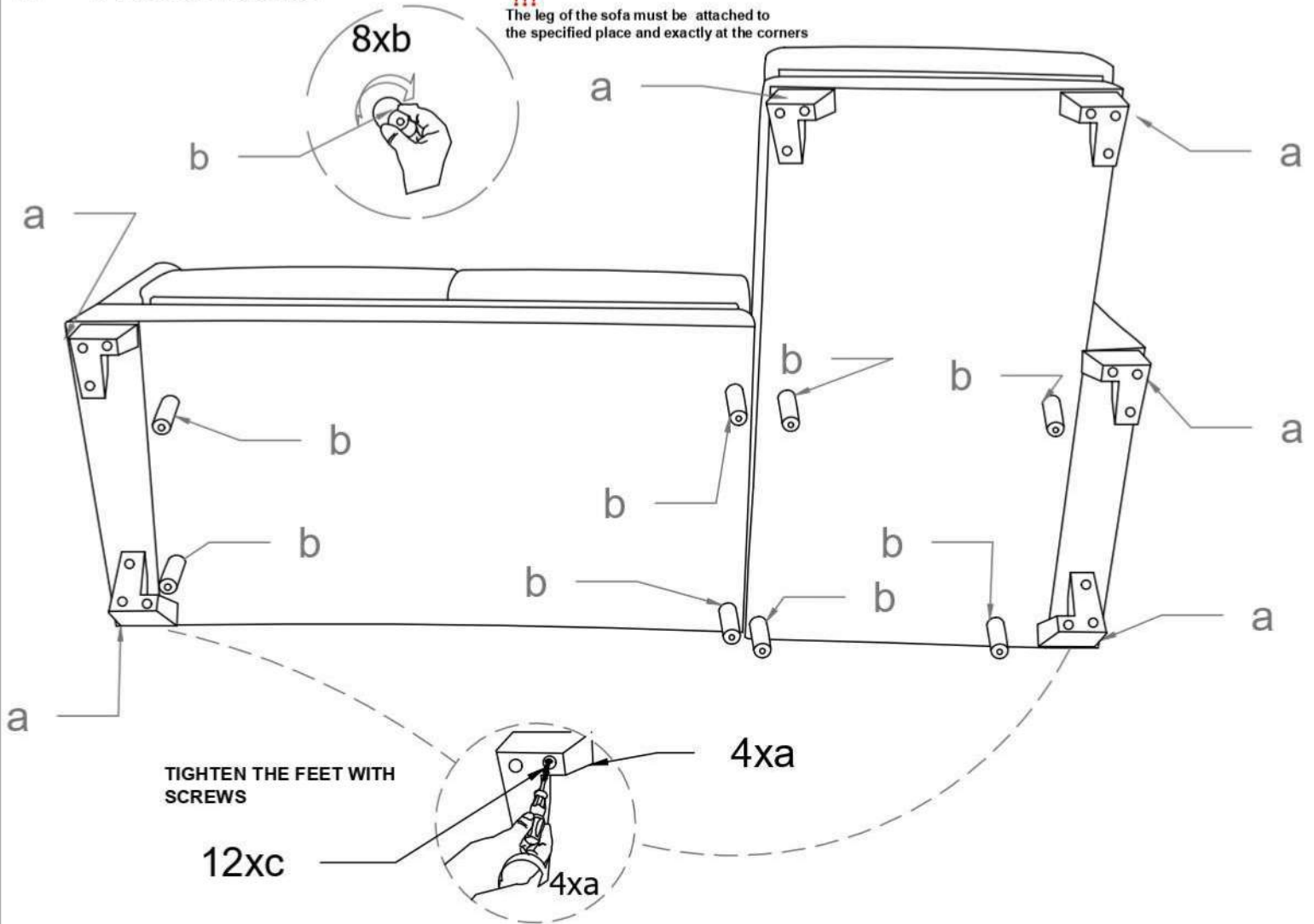

WARNING !!!

Attach All The Feet And Lift The Product

5. PROCEDURE

SEAT READY TO USE

