

HARDWARE ITEM			QTY
A2		Screw m3.5 x 14mm	96
A7		Screw m4 x 30mm	10
A10		Screw m4 x 38mm	4
A17		Crosshead Screw m6.3 x 40mm	34
A34		Euro Screw m5 x 8mm	4
D4		Wood Dowel 6 x 25mm	4
E7		Door Hinges 2/8"	5
E8		Door Hinges 5/8"	5
F2		Mini Fix 15mm	4 Sets
H6		Handle 128mm	5
L2		Plastic Leg L Shape	6
M7		Drawer Metal Slide 400mm	1 Sets
N1		Allen Key	1
N3		Nail	90 (+-3)
P		Hanging Steel Pipe 18mm x 588mm	1
R1		L Bracket	2
R2		Single Plastic Cap	6
S2		Door Stopper	2
Y		Crosshead Cover	24

COMPLETE

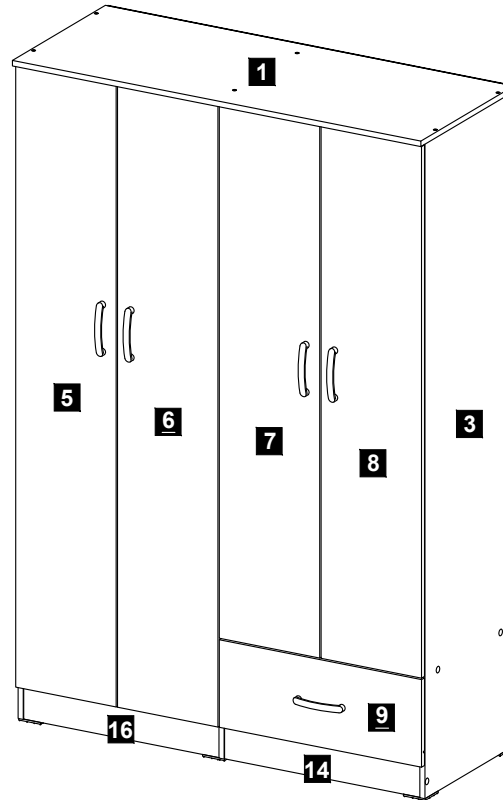

PRE - ASSEMBLY

STEP 1 Insert the Wood Dowel 6 x 25mm (D4) at panel no. 16. Then, insert the Door Stopper (S2) at panel no. 1.

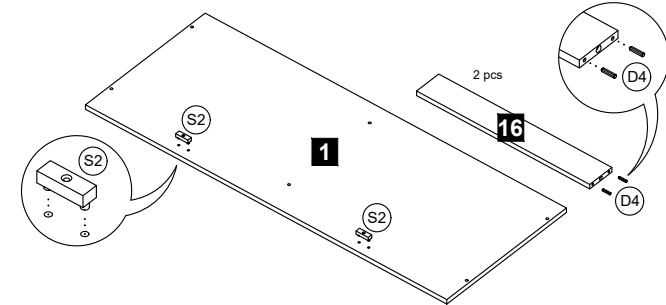

STEP 2 Assemble the Drawer Metal Slide 400mm (M7) at panel no. 3 & 4 by using Euro Screw m5 x 8mm (A34).

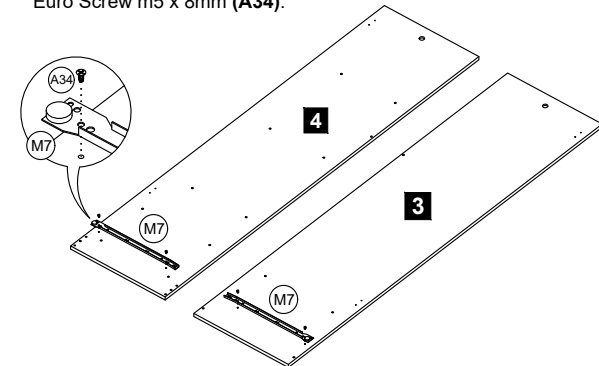

STEP 3 Assemble the Handle (H6) at panel no. 5, 6, 7 & 8 by using Screw m4 x 30mm (A7). Then, assemble the Door Hinges 2/8" (E7) at panel no. 6 & 7 and Door Hinges 5/8" (E8) at panel no. 5 & 8 by using Screw m3.5 x 14mm (A2).

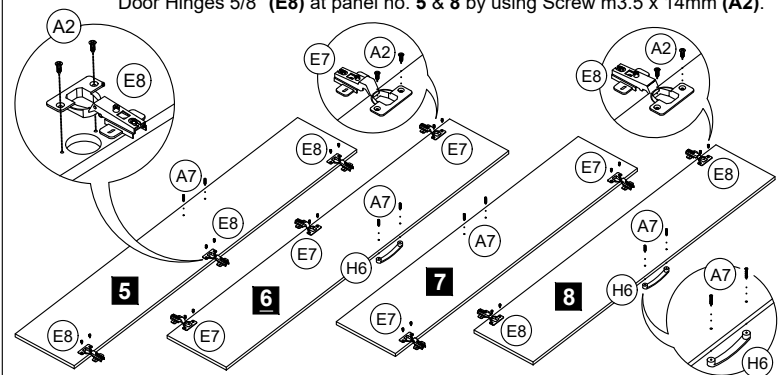

CAUTION

MATERIAL USE LAMINATED PARTICLE BOARD, TO CLEAN USE SOFT, DRY CLOTH. DO NOT USE DETERGENT OR CHEMICAL AVOID CONTACT WITH WATER AND DIRECT SUNLIGHT. TO BE ASSEMBLED ON A SOFT, DRY, CLEAN SMOOTH SURFACE.

USE OF POWER TOOLS TO ASSEMBLE THIS PRODUCT WILL INVALIDATE ANY CLAIM AND MAY DAMAGE THIS PRODUCT MAKING IT UNSAFE.



STEP 4 Insert the Mini Fix Bolt (F2) & assemble the Handle (H6) by using Screw m4 x 30mm (A7) at panel no. 9. Then, insert the Mini Fix Cam (F2) at panel no. 10 & 11.

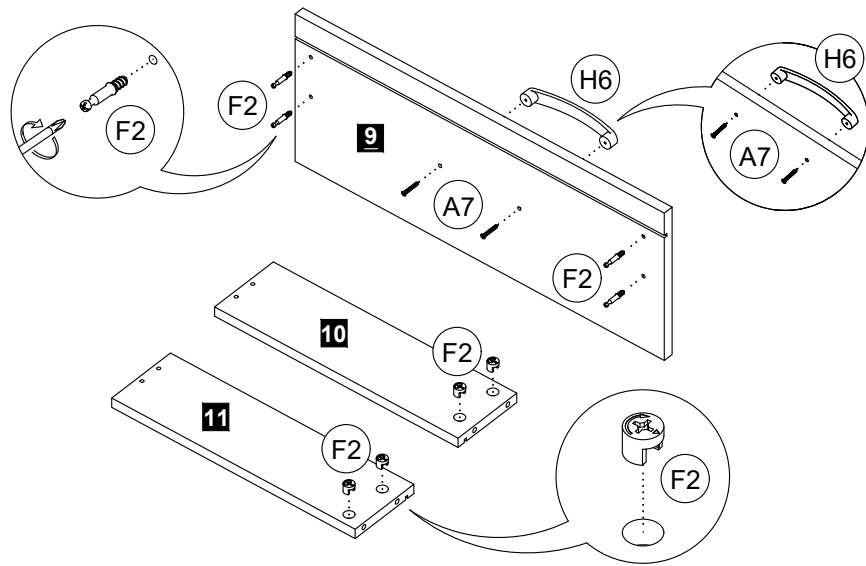

STEP 5 Assemble the panel no. 10, 11 & 17 together by using Screw m4 x 38mm (A10).

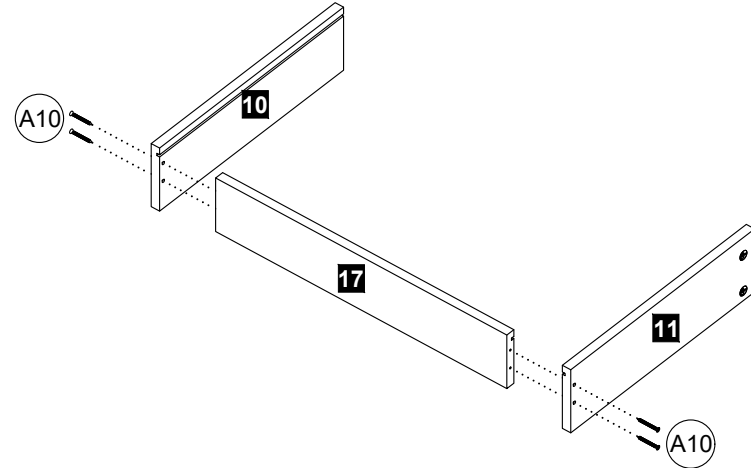

STEP 6 Slide the bottom panel no. 19 until the groove end & assemble the drawer front panel no. 9 by using Mini Fix 15mm (F2).

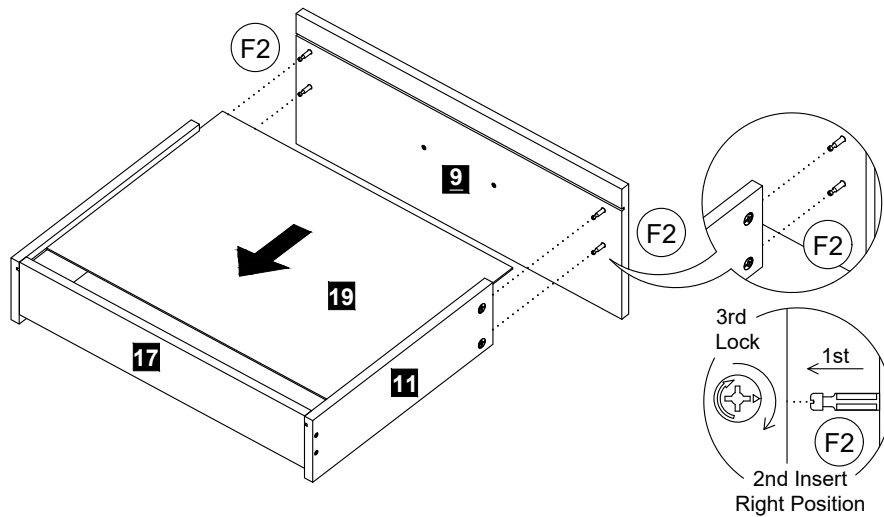

STEP 7 Assemble the Drawer Metal Slide 400mm (M7) & use Single Plastic Cap (R2) to secure the drawer bottom panel by using Screw m3.5 x 14mm (A2).

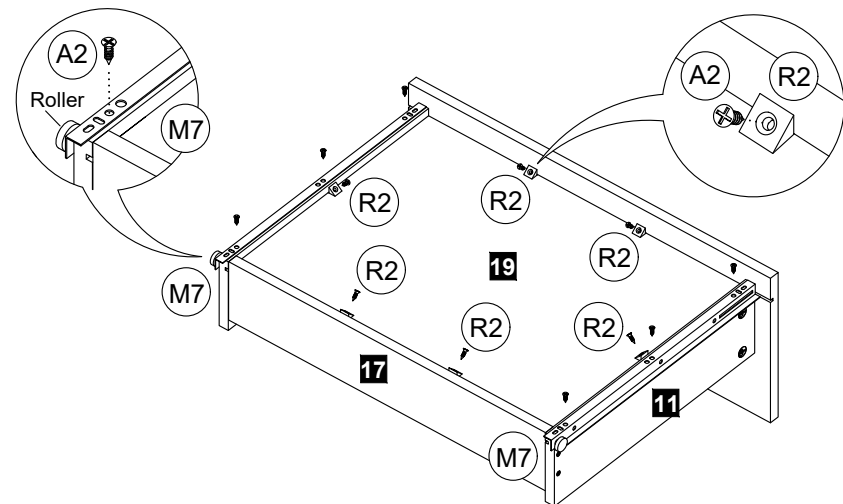

STEP 8

Insert the Hanging Steel Pipe 18 x 588mm (P) until the large marking hole at panel no. 3. Assemble panel no. 3, 4, 12, 14 & 15 together by using Crosshead Screw m6.3 x 40mm (A17). Use Allen Key (N1) to tighten the Crosshead Screw m6.3 x 40mm (A17) & button the screw head with Crosshead Cover (Y) except the bottom of panel no. 4.

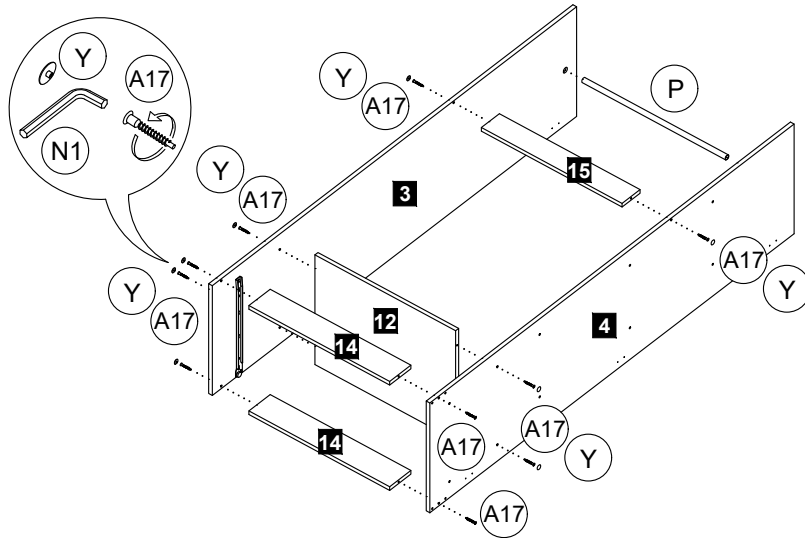

STEP 9

Assemble the panel no. 2, 12, 13 & 16 to the unit by using Wood Dowel 6 x 25mm (D4) & Crosshead Screw m6.3 x 40mm (A17). Use Allen Key (N1) to tighten the Crosshead Screw m6.3 x 40mm (A17) & button the screw head with Crosshead Cover (Y) except the bottom of panel no. 4.

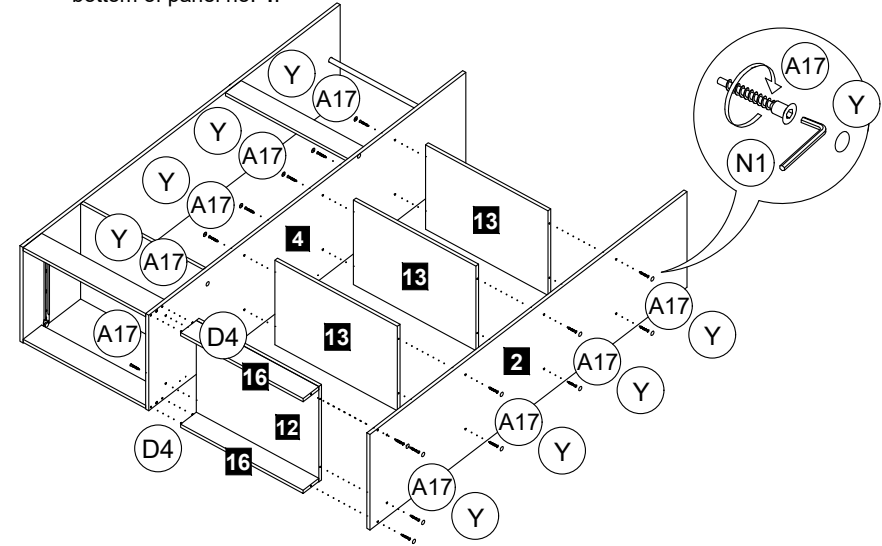

STEP 10

Assemble the panel no. 1 to the unit by using Crosshead Screw m6.3 x 40mm (A17). Use Allen Key (N1) to tighten the Crosshead Screw m6.3 x 40mm (A17).

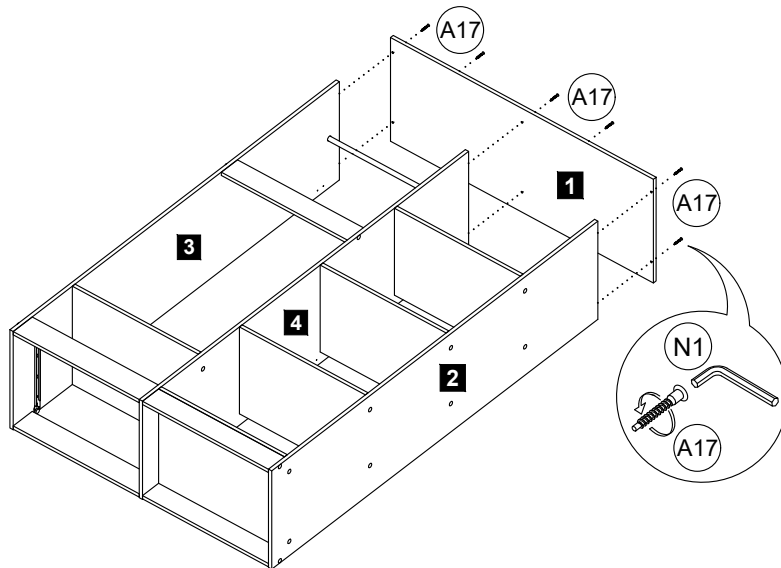

STEP 11

Attach the panel no. 18 to the unit by using Nail (N3). Use Screw m3.5 x 14mm (A2) to secure the panel no. 18 to panel no. 14, 15 & 16. Then, assemble the L Bracket (R1) by using Screw m3.5 x 14mm (A2) at between panel no. 12 & 16. Assemble the Plastic Leg L Shape (L2) by using Screw m3.5 x 14mm (A2) at between panel no. 2, 3, 4, 14 & 16.

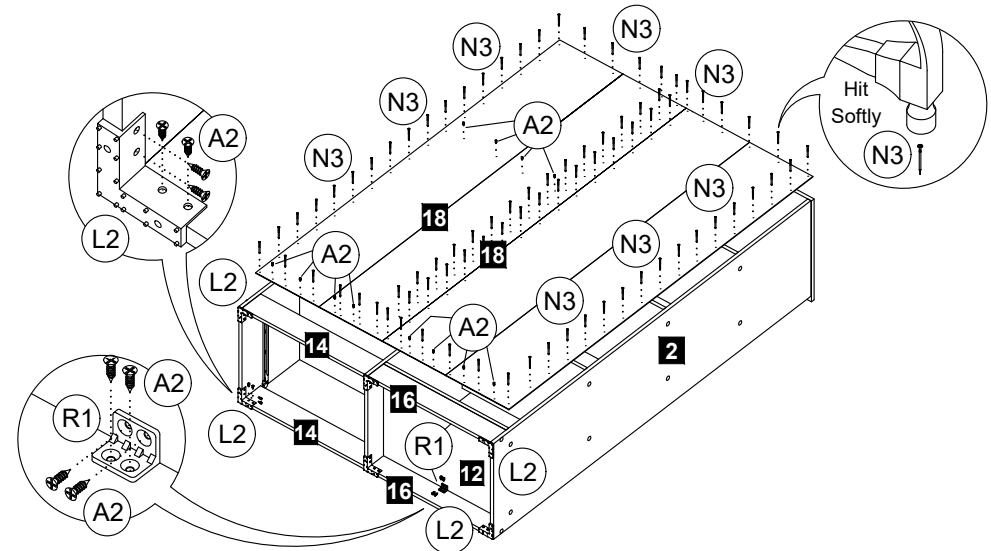

STEP 12 Insert the drawer to the unit.

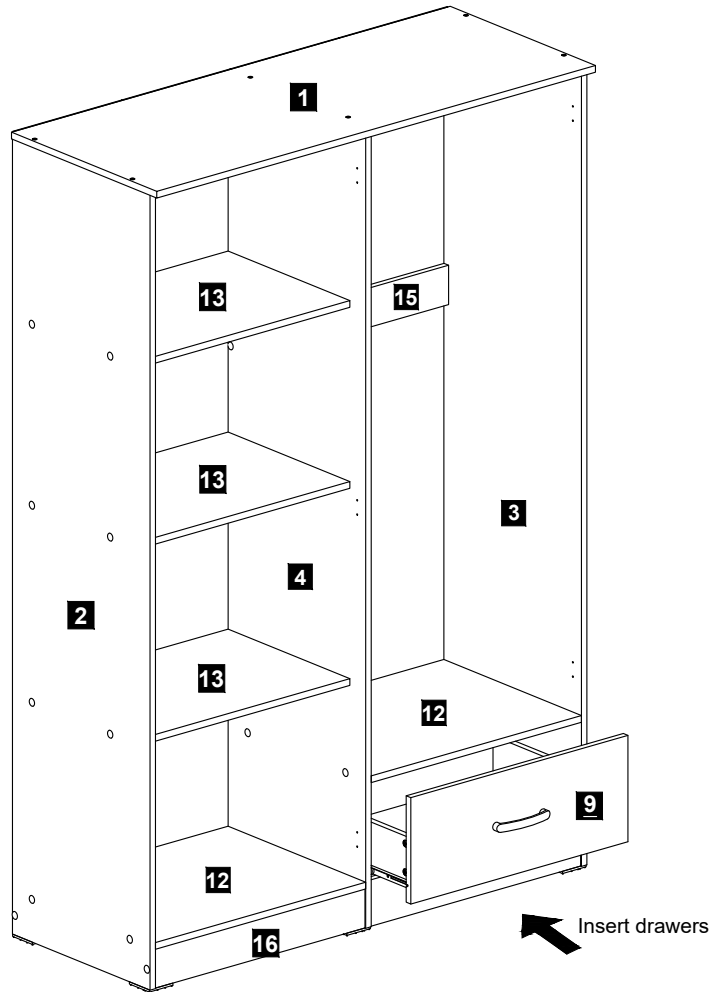

Stand up

STEP 13 Attach the door panels no. 5, 6, 7 & 8 to the unit. Adjust the Door Hinges 2/8" (E7) & Door Hinges 5/8" (E8) to screw parallel between door gaps by using Screw m3.5 x 14mm (A2).

