

Components:

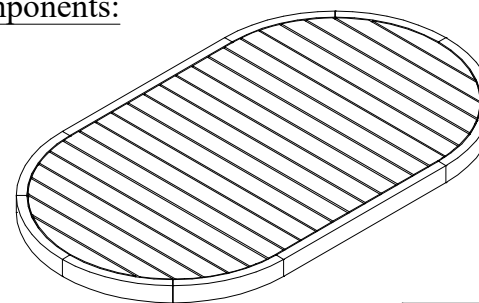

A. TABLE TOP X 1

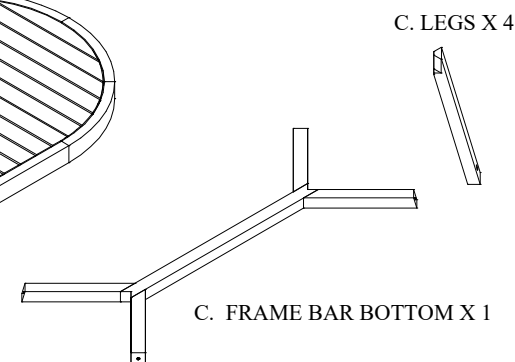

C. FRAME BAR BOTTOM X 1

C. LEGS X 4

① WASHERS = 8pcs



③ SCREW M6 x 55mm = 4pcs

② BOLT M6 x 45mm = 8pcs

④ ALLEN KEY 4 = 2pcs

These instructions must be used to ease the assembly of your furniture.
Please ensure that you have all the components before assembly.
Remember to place the part on a carpeted floor or blanket in order to protect them from damage while you assemble.

Step 1:

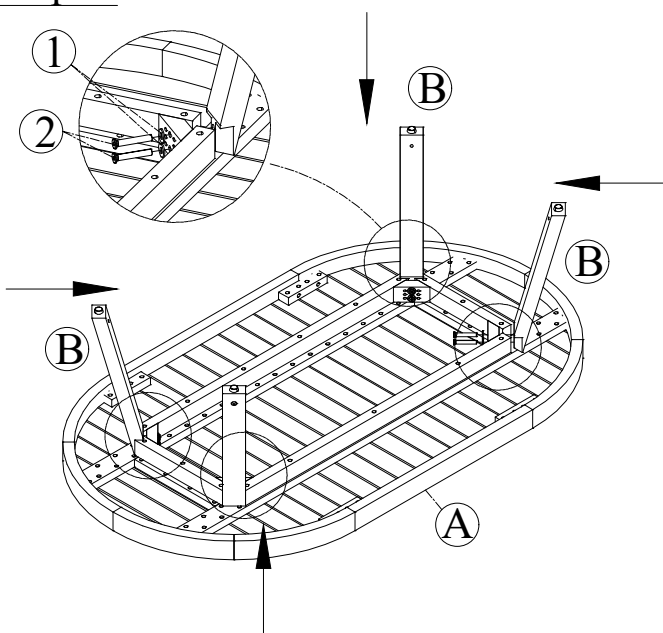

Step 2:

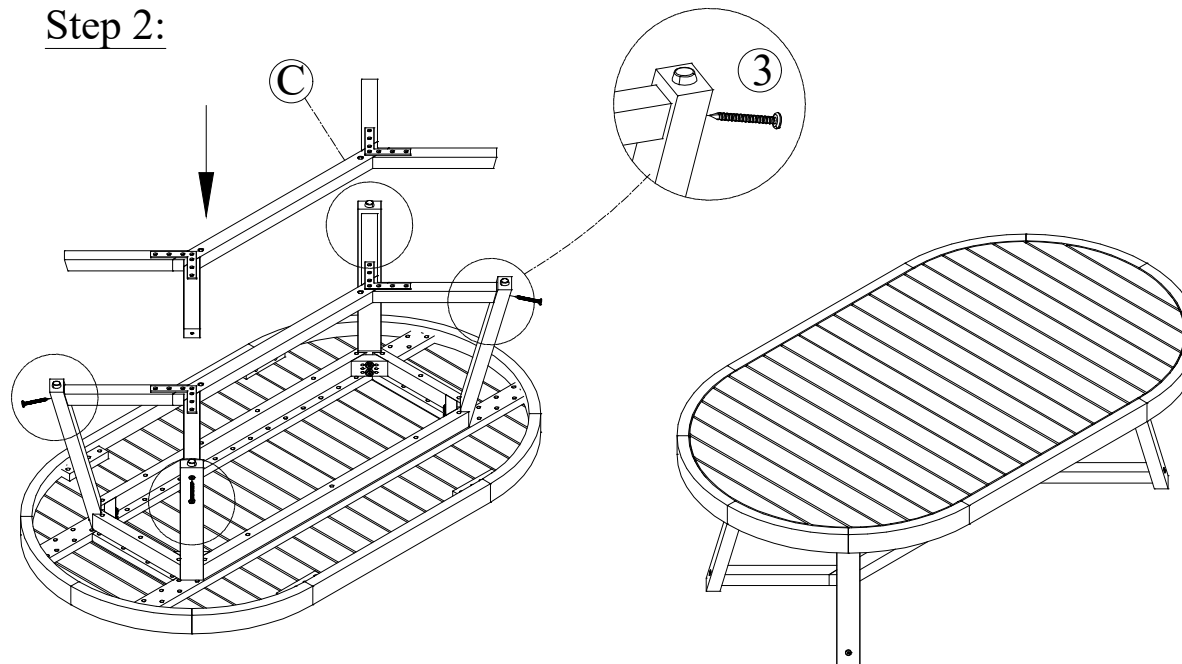

Finished