

Before starting the assembly need to

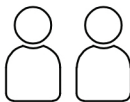

2 Person



Electric Screwdriver



Philips Screwdriver



Hammer

### Warnings;

- Children / pets may swallow small parts and choke as a result. Do not allow children/pets to play with small parts and keep them away from these parts.
- Carefully follow the assembly instructions that included in the product box. Make sure that the parts are assembled completely and without damage.
- The weight of the product may cause injuries during lifting. Do not carry the product alone. Carry the product with at least two people.
- The product has a 2 year warranty.
- For your safety, we recommend fixing the product to the wall.

### Before Assembly;

- Obtain the necessary tools specified in the manual.
- Clean all parts with a damp cloth.
- Group the accessories / hardware items.
- Carefully place the parts in a suitable area according to their numbers. At this stage, be careful not to rub the parts against each other and not to hit the corners.

### During Assembly;

- Follow all the steps in the manual carefully in order.
- Make sure the screws are tightened properly.
- It is recommended that carrying the product by lifting it with two people, without letting it slide on the ground.

### Usage Recommendations;

- Do not expose the product to direct sunlight.
- Keep away from water and heat.
- Place the product on a flat and suitable surface.
- Place the weight balanced on the product.
- Do not use harmful chemicals to clean the product. Clean it with a damp cloth.
- Do not climb on or sit on the furniture.

### Packing Information;

- Our packaging materials are recyclable.
- Do not throw away with household or other waste. Throw them to the recycling points.



1

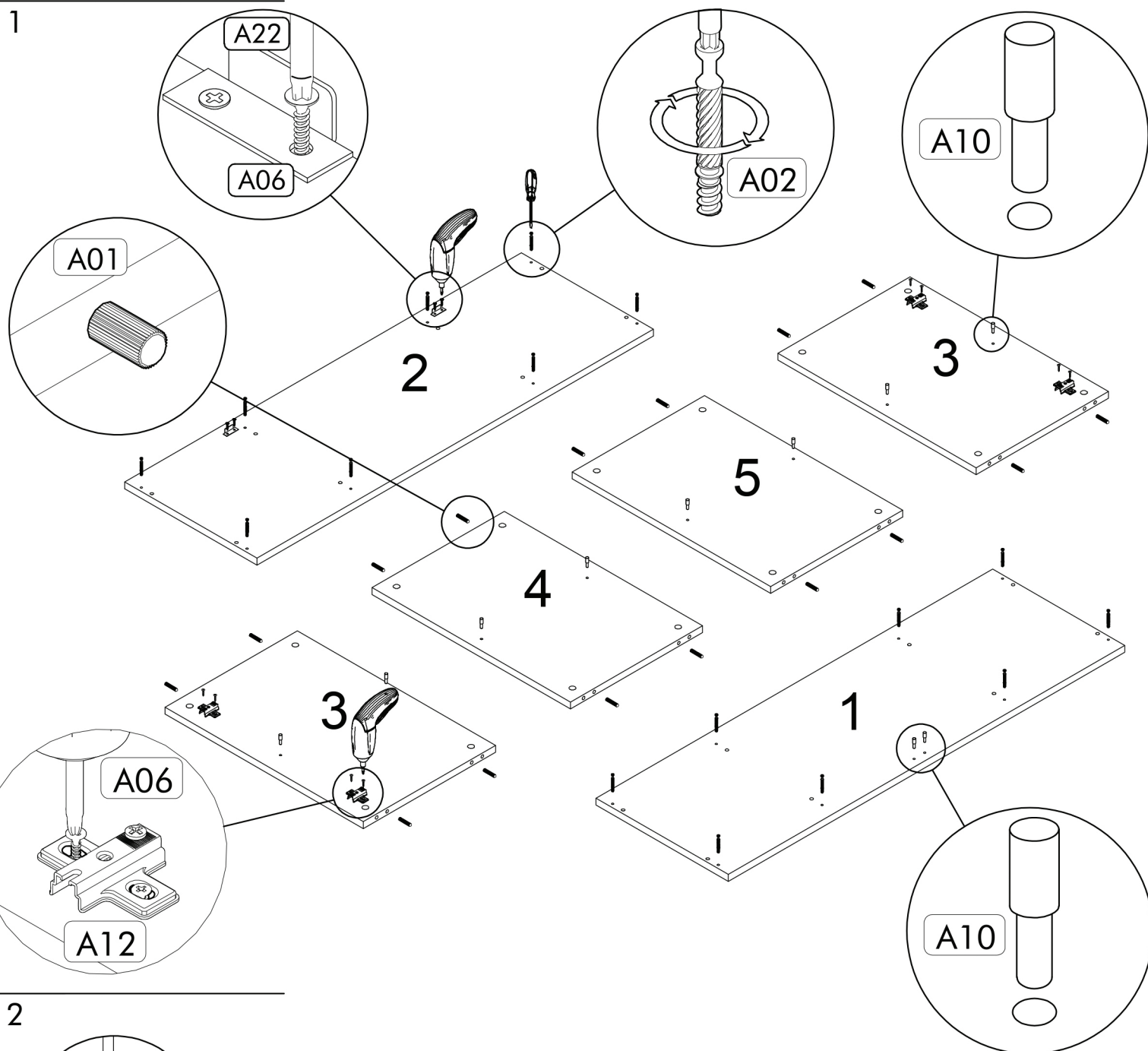

2

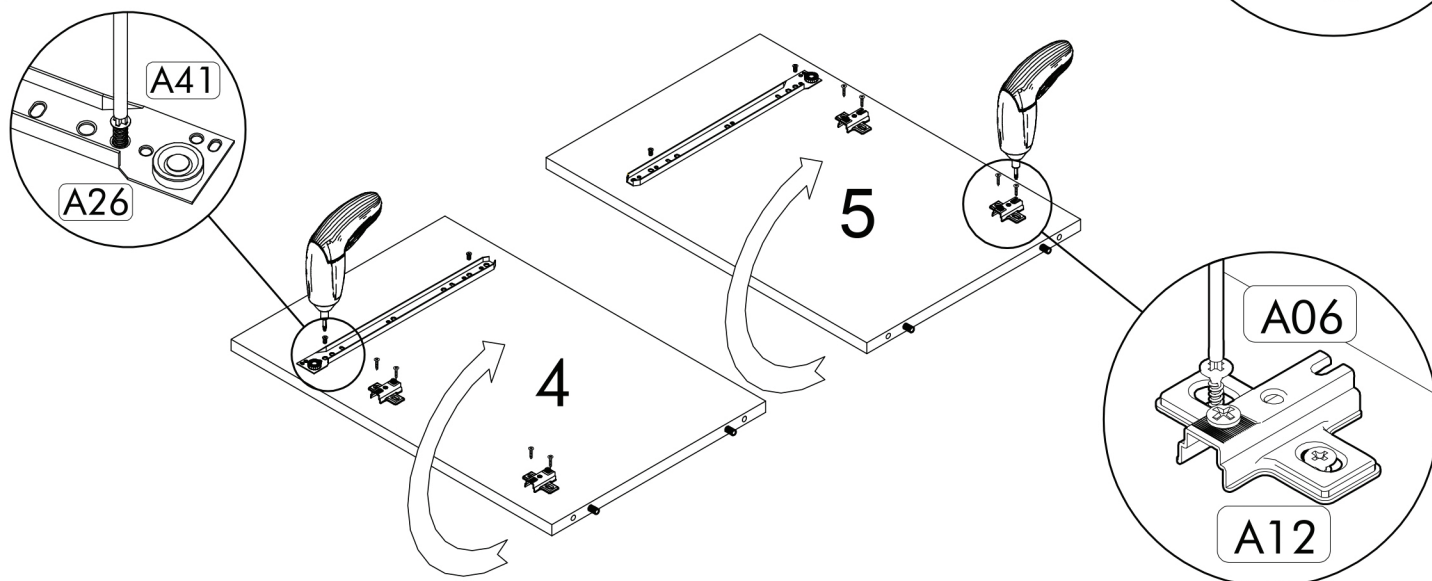



3

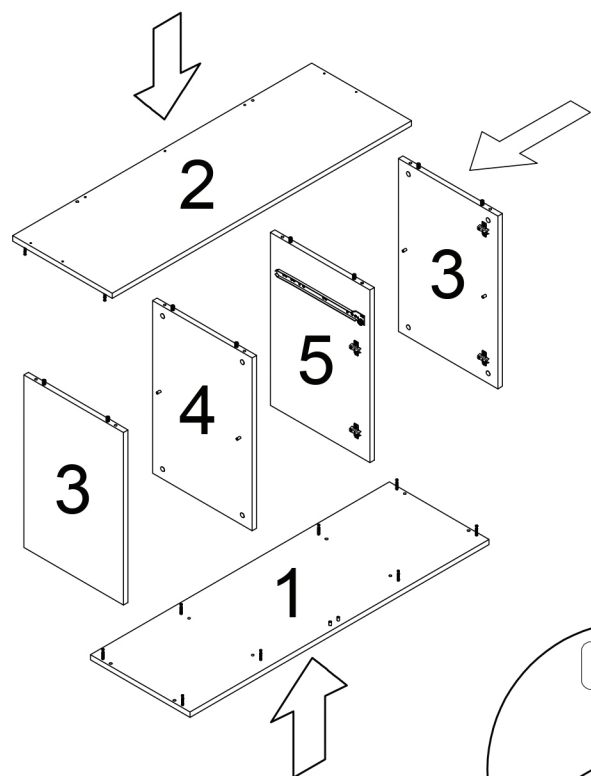

4

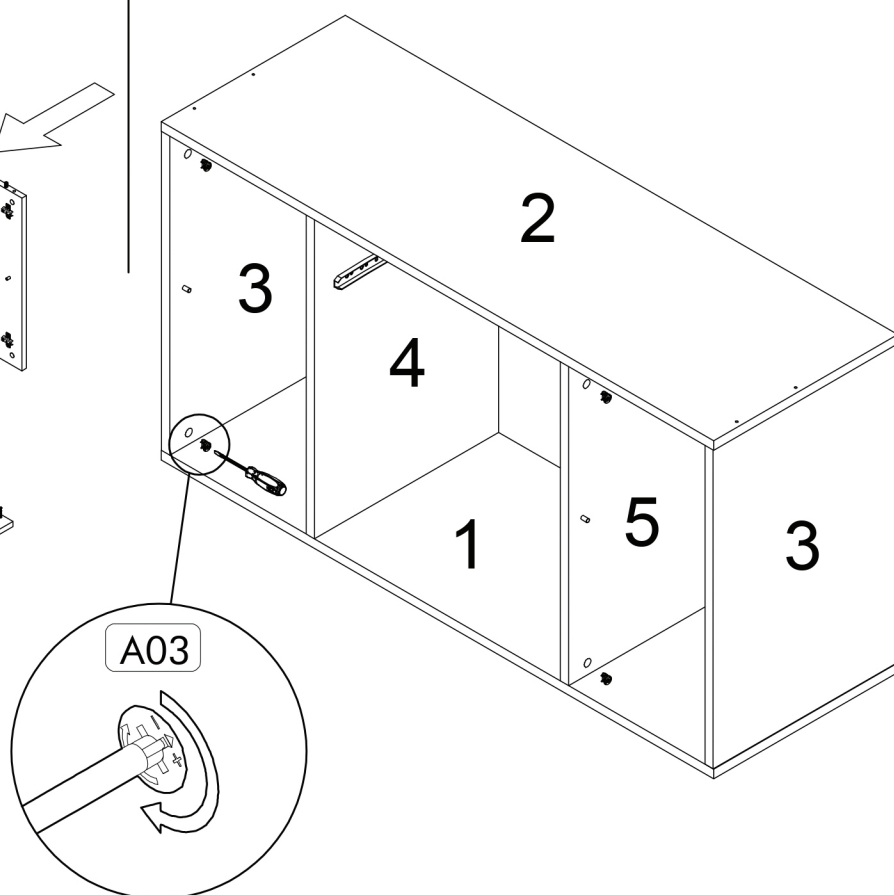

5

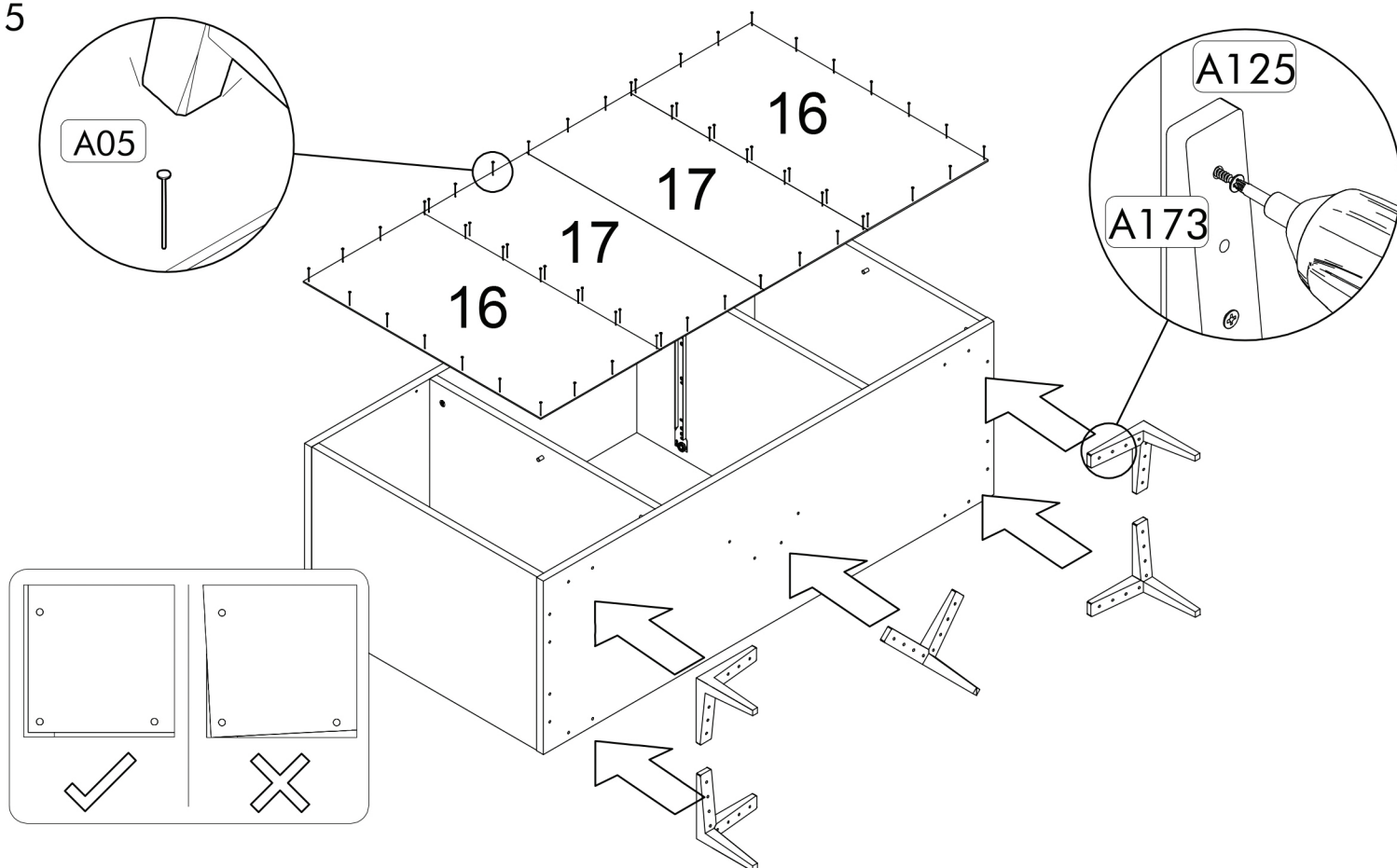

6

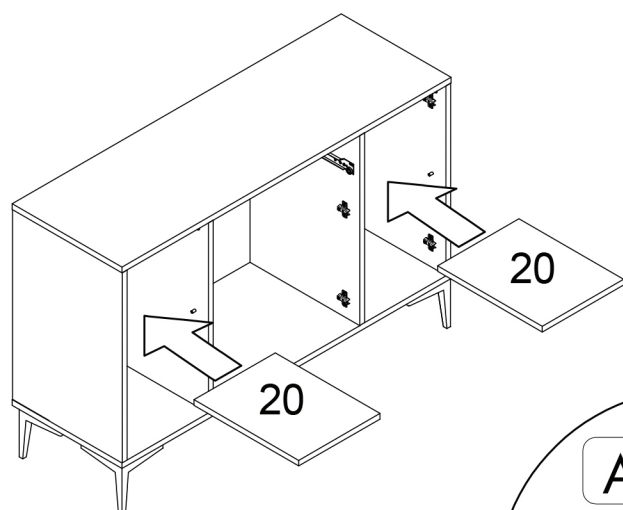

7

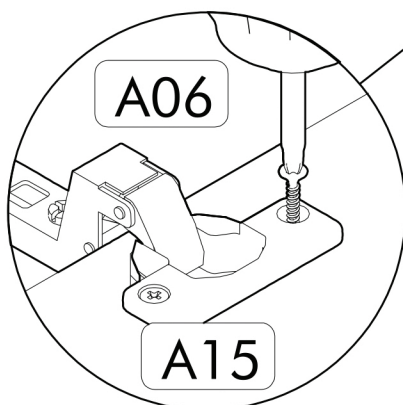
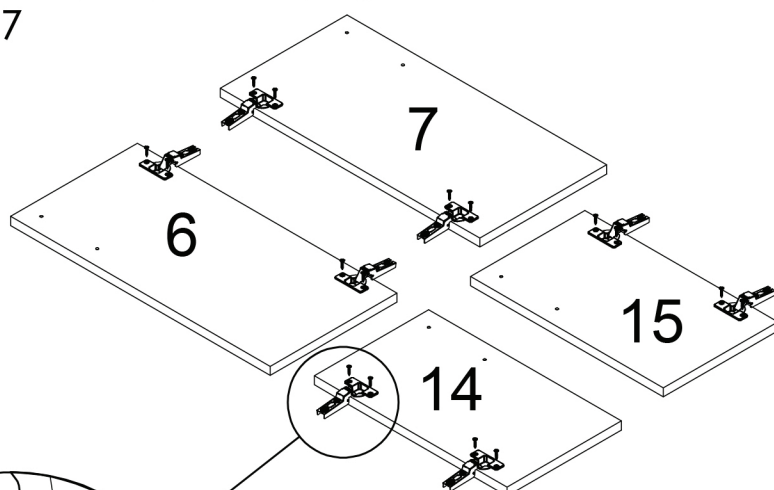

8

