

MODEL: SOPHIA BED

ASSEMBLY INSTRUCTIONS

STEP 1

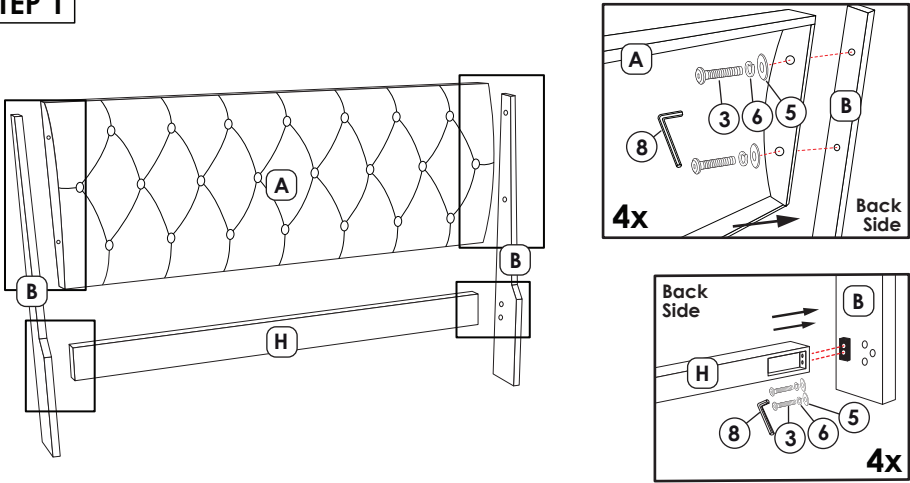

STEP 2

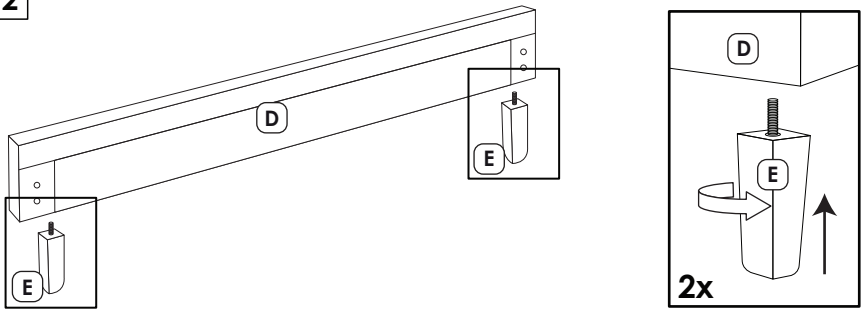

STEP 3

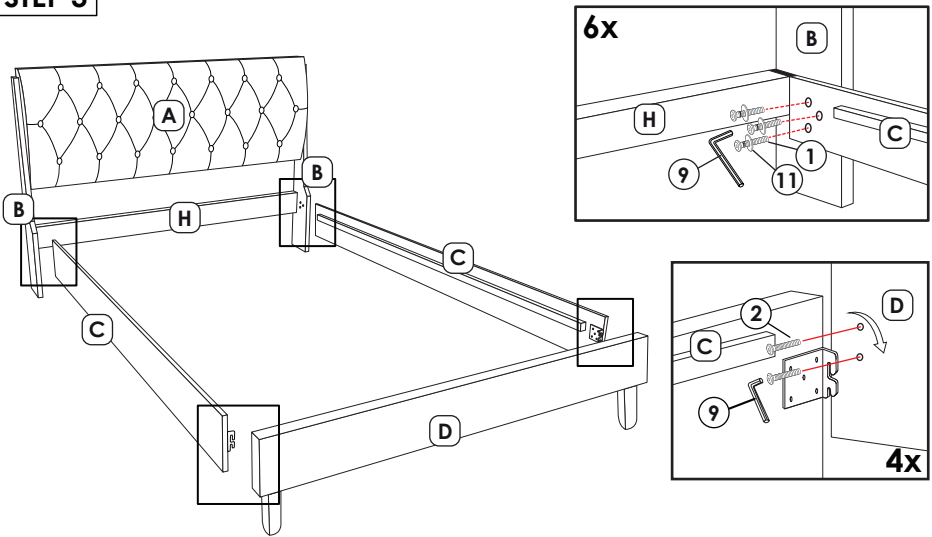

STEP 4

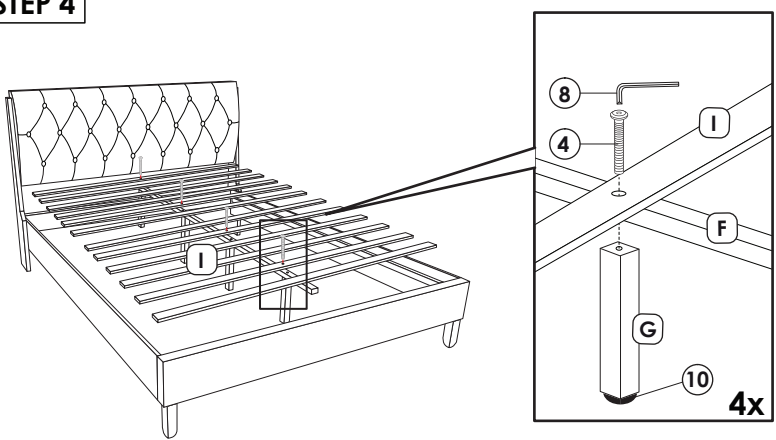

STEP 5



NO	PART LIST	QTY
A	Headboard	1 pc
B	Headboard Wing	2 pcs
C	Side Rail	2 pcs
D	Footboard	1 pc
E	Footboard Leg	2 pcs
F	Center Rail	1 pc
G	Center Rail Leg	4 pcs
H	Support Bar	1 pc
I	Bed Slat	12 pcs

NO	HARDWARE LIST	QTY
1	JCBB M8 x 40mm	6 pcs
2	JCBC M8 x 20mm	4 pcs
3	JCBC M6 x 40mm	8 pcs
4	JCBC M6 x 60mm	4 pcs
5	Flat Washer M6	8 pcs
6	Spring Washer M6	8 pcs
7	CSK M4 x 32mm	24 pcs
8	Allen Key M4	1 pc
9	Allen Key M5	1 pc
10	Adjuster M6	4 pcs
11	Flat Washer M8	6 pcs

Read this instruction carefully. Remove all wrapping material, staples and straps from the carton. See hardware and furniture part list for guidance. Be sure you have all wooden furniture parts on a clean and flat soft surface, such as a carpet or rug, to prevent from being scratched.

CAUTION :

1. Do not FULLY - TIGHTEN the nut or screw until all ready to assemble.
2. Do not OVER - TIGHTEN the nut or screw to avoid causing damages to the thread.
3. Keep all hardware part out reach of children.



COMPLETE ASSEMBLE